

Pop-up tents with printed graphics

Frame Tent Specifications

Tent size when assembled: 20' x 30' = 600 sq. ft.

Tent Height / Head Clearance: 7' 8"

Overall tent height: 12' – ground to top peak

Tent Top Pitch: 5'

Weight of double barrel frame:

Class Tent : 20' x 30' Canopy with double barrel frame tent

Expandable: No - One piece tent top

Digital Printing: Can be ordered for the tent / Graphics will not chip or peel / can be washed

Tent Material: 16 oz. Block out PVC vinyl: Includes UV and NFAP 701 fire coating: Made in the USA

Tent top: 100% Waterproof / 120 lbs.

Anodized Aluminum Poles: Double barrel pole measures 2" x 4" x 1/8" thick / 425lbs.

Tent Connectors: Zinc plated galvanized steel connectors / No rusting / 170 lbs.

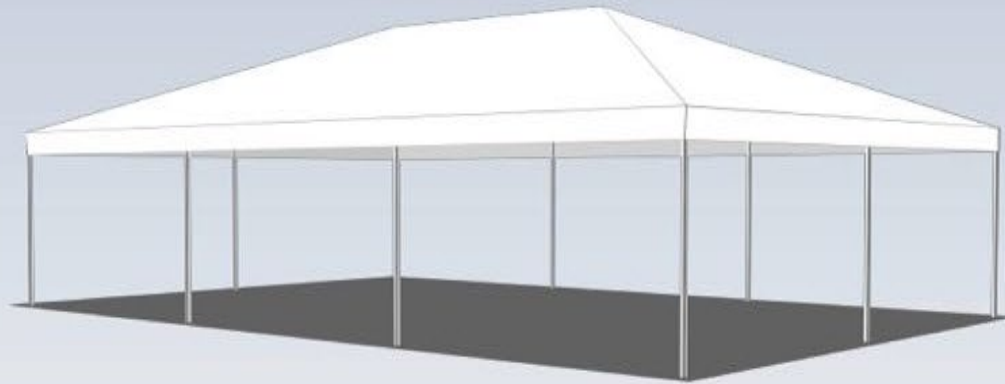
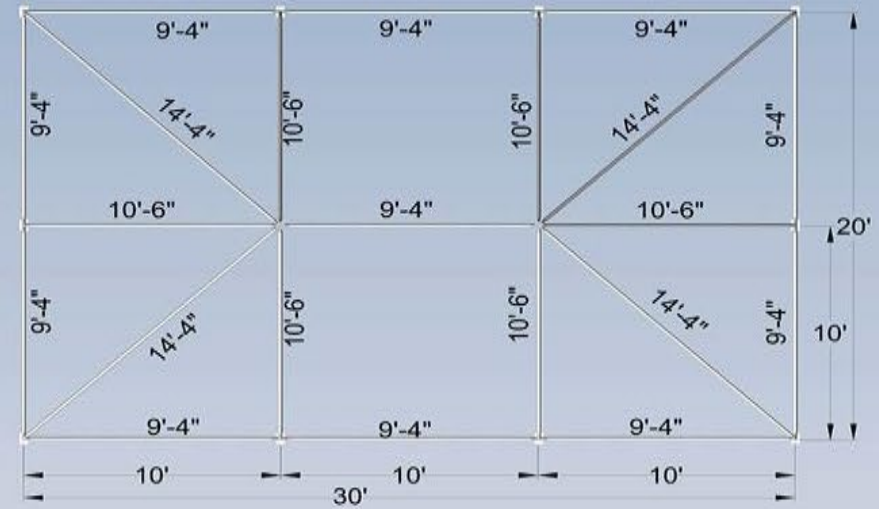
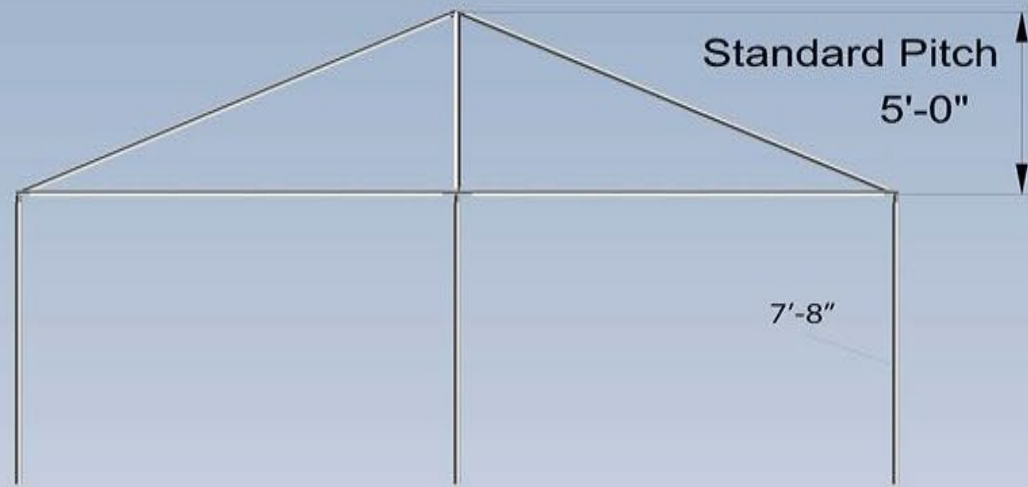

	Poles	Usage	Color
11	9'4"	Spreader	White
4	14'4"	Hip Rafter	Red
6	10'6"	Rafter	Green
10	7'8"	Legs	Black

	Fittings
4	Corner
6	Side Tee Joint
2	6 Way Crown
62	Canopy Pins

	Top & Sidewalls	Size
1	Complete Top STD Frame	20 x 30

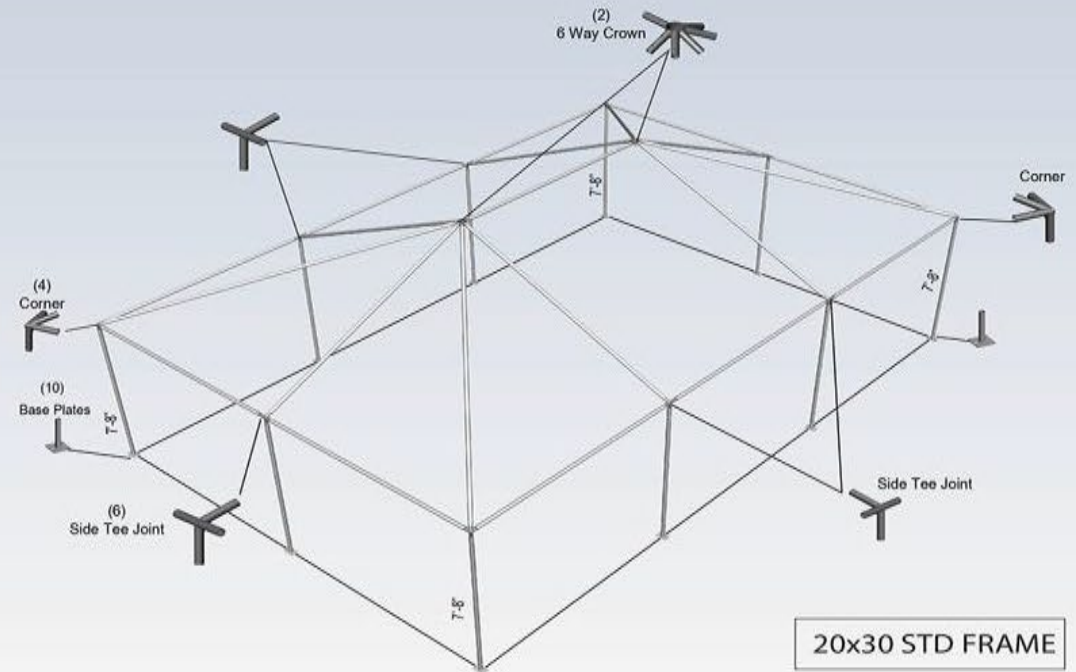



20x30 DT Frame			
TYPE	DIMENSIONS	WEIGHT	
Bundle	233x8x6	145 LBS	
Bundle	174x8x9	150 LBS	
Bundle	174x8x7	130 LBS	
	On the Pallet		
Sandbags		55 LBS	
Connectors		170 LBS	
Top		120 LBS	
Pallet		55 LBS	
Pallet Total	48" x 40"	455 LBS	